

- 1) Area in which display is to be sited must have a minimum room volume no less than 109 cu m.
- 2) Install over a sealed floor or ventilated floor void.
- 3) Do not site the display within 2m of ceiling mounted air conditioning grilles.
- 4) Do not site the display beneath a high level of direct sunlight.
- 5) Display will operate in a 24 hour environment.
- 6) Access to maintain condensing unit should be made via removable fascia panels or doors to customer and operator side of counter.

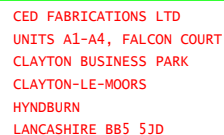

© CED FABRICATIONS LTD

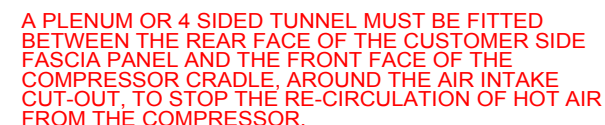
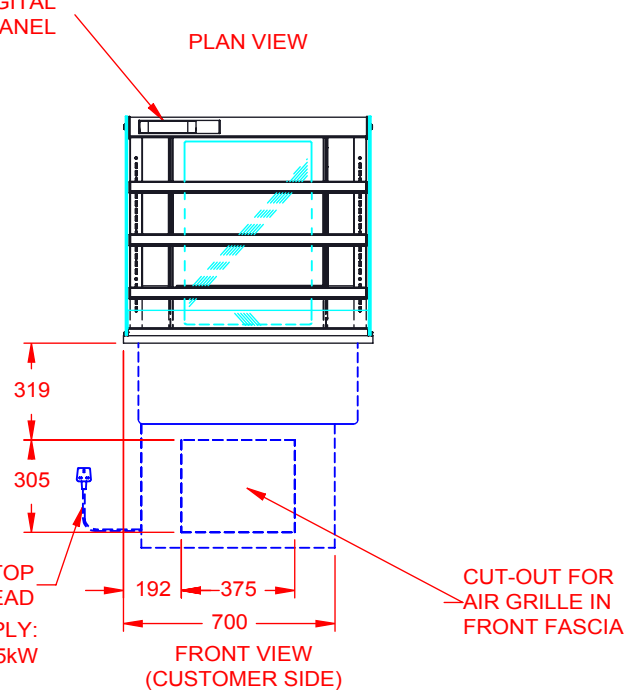
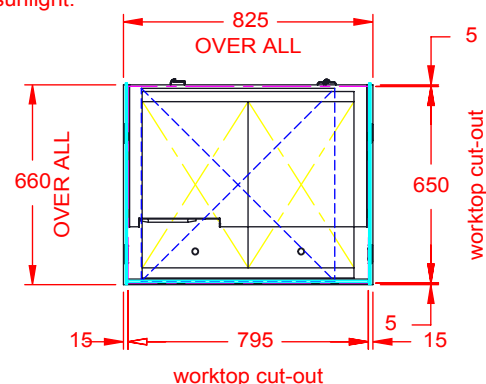
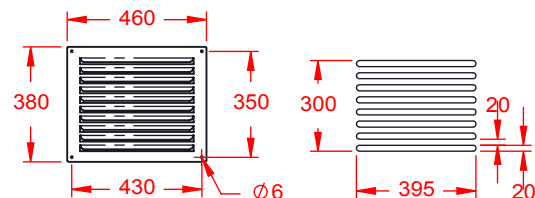
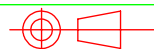

DESIGNLINE DROP-IN CHILLED
2-1 G_N MULTIDECK - WITH DOORS
- HYDROCARBON TYPE-R290 REFRIGERANT

REV No:

MDR 2 HT