



General Installation Considerations

- 1) Area in which display is to be sited must have a minimum room floor area no less than 17 sq m (SCDDL2HT & SCDDL3HT), 20 sq m (SCDDL4HT) or 28 sq m (SCDDL5HT).
- 2) Install over a sealed floor or ventilated floor void.
- 3) Do not site the display within 2m of ceiling mounted air conditioning grilles.
- 4) Do not site the display beneath a high level of direct sunlight.
- 5) Display will operate in a 24 hour environment.
- 6) Access to maintain condensing unit should be made via removable fascia panels or doors to customer and operator side of counter.

A) WORKTOP CUT-OUT

Model Ref.	Worktop Cut Out Size (mm)		Model Weight (in Kg)
	Length	Width	
SCDDL2HT+SAF1	795	825	131
SCDDL3HT+SAF1	1145	825	153
SCDDL4HT+SAF1	1495	825	184
SCDDL5HT+SAF1	1845	825	217

FIX LIFTING BRACKETS TO FRAME END FLANGES USING SCREWS ALREADY IN FLANGES, THEN LOCATE LIFTING BARS INTO SQUARE HOLES.

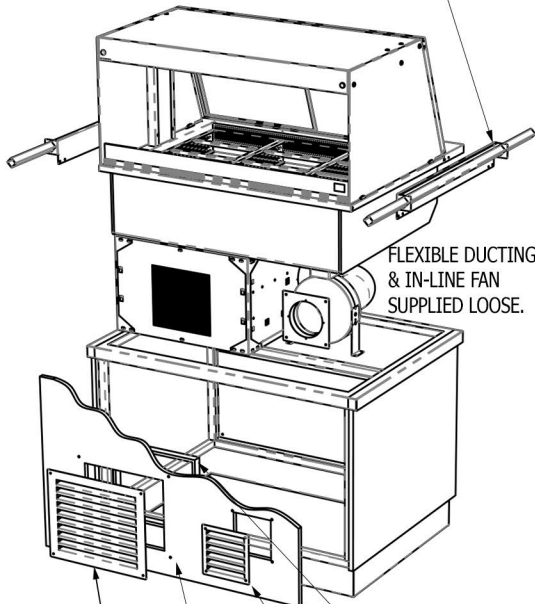

FLEXIBLE DUCTING & IN-LINE FAN SUPPLIED LOOSE.

B) AIR INTAKE & OUTLET CUT-OUTS (CUSTOMER SIDE FASCIA PANEL)

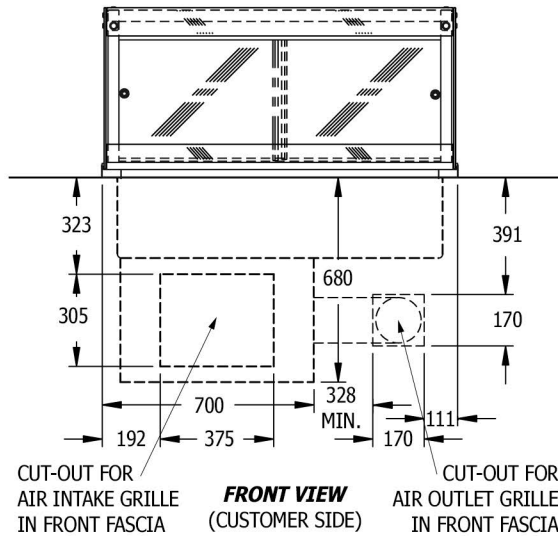

D) AIR INTAKE TUNNEL / PLENUM FITTING (CUSTOMER SIDE FASCIA PANEL)

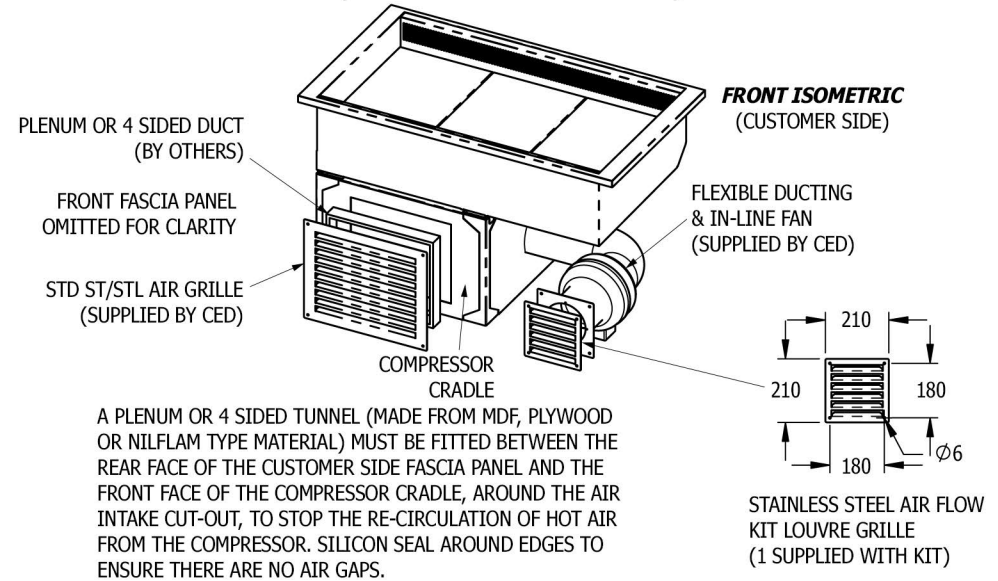

C) FITTING INTO COUNTER WORKTOP

RE-ATTACH FLEXIBLE DUCTING & IN-LINE FAN TO SIDE OF COMPRESSOR CRADLE ONCE UNIT HAS BEEN DROPPED INTO PLACE. ELECTRICALLY CONNECT FAN TO CONTROL BOX WITH "KETTLE PLUG"

REMOVE LIFTING BRACKETS AFTER FITTING AND REPLACE SCREWS INTO FRAME END FLANGES

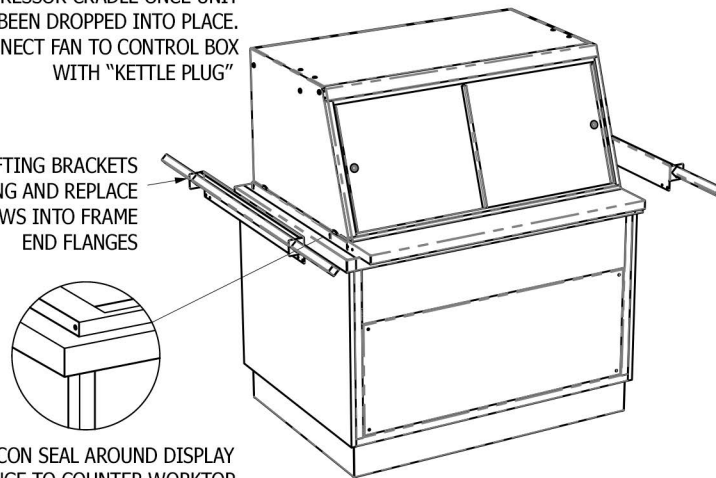

E) FITTING OF LOUVRE GRILLES

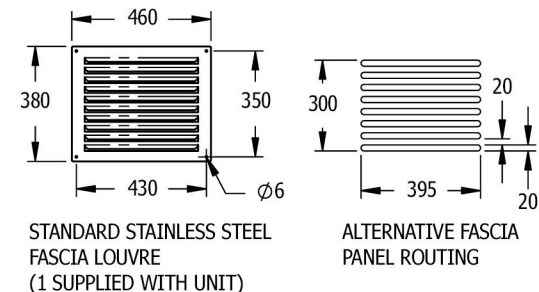

FRONT ISOMETRIC (CUSTOMER SIDE)

REAR ISOMETRIC (OPERATOR SIDE)

