

PLAN VIEW

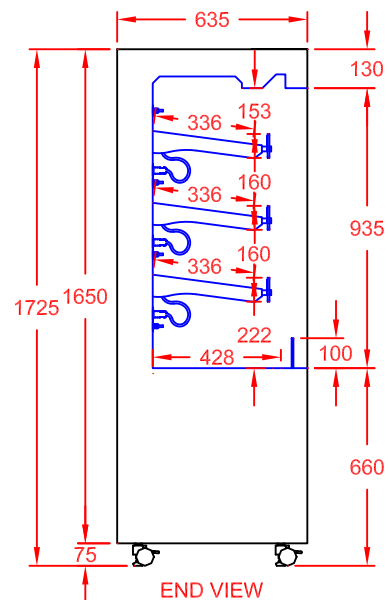

END VIEW

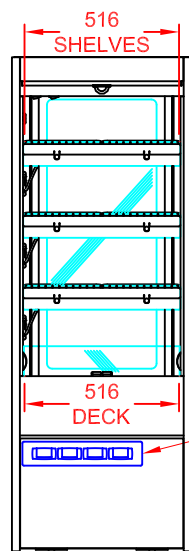

FRONT VIEW
(CUSTOMER SIDE)

CONTROL PANEL
(BEHIND LIFT-OFF PANEL)
c/w DIGITAL CONTROLS
FOR EACH HEATED TIER

LOCKABLE CASTORS
WITH ADJUSTABLE
CENTRE FOOT
(SPANNER SUPPLIED)

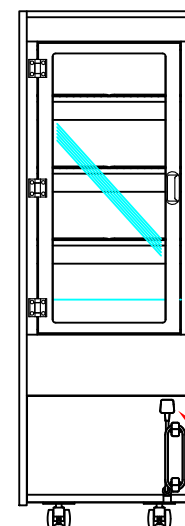

REAR VIEW
(OPERATOR SIDE)

13A PLUG TOP
& 2m LEAD
POWER SUPPLY:
13A, 230V, 2.57kW

CAPACITY: 134L

APPROX. UN-CRATED
WEIGHT OF UNIT: 112Kg



CED FABRICATIONS LTD
UNITS A1-A4, FALCON COURT
CLAYTON BUSINESS PARK
CLAYTON-LE-MOORS
HYNDBURN
LANCASHIRE BB5 5JD

This drawing and information herein is confidential to CED Fabrications Ltd. It is issued in confidence that it will not be disclosed to any third party in part or in whole without permission from CED FABRICATIONS Ltd.

© CED FABRICATIONS LTD



DESCRIPTION:

MONEY MAKER HEATED MERCHANDISER
600mm 3 TIER SLIM (NIGHT BLIND)
WITH REAR HINGED DOOR OPTION

SCALE: 1 : 25 @ A4 REV No: A

PRODUCT CODE: MMH600S+MMHDR6S