

Ventilation / Display Performance Considerations

- 1) Area in which display is to be sited must have a minimum room floor area no less than 17 sq m.
- 2) Install over a sealed floor or ventilated floor void.
- 3) Do not site the display within 2m of ceiling mounted air conditioning grilles.
- 4) Do not site the display beneath a high level of direct sunlight.
- 5) Display will operate in a 24 hour environment.
- 6) Access to maintain condensing unit should be made via removable fascia panels or doors to customer and operator side of counter.

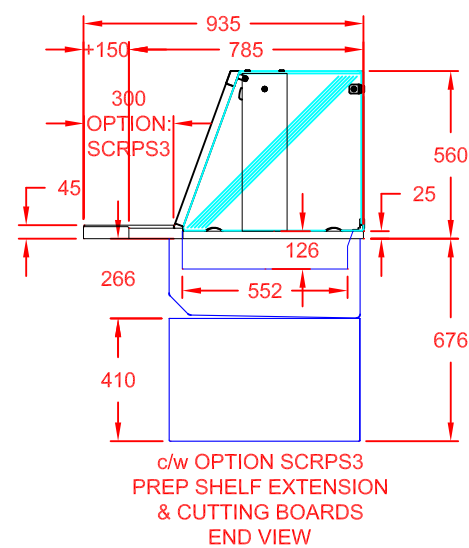
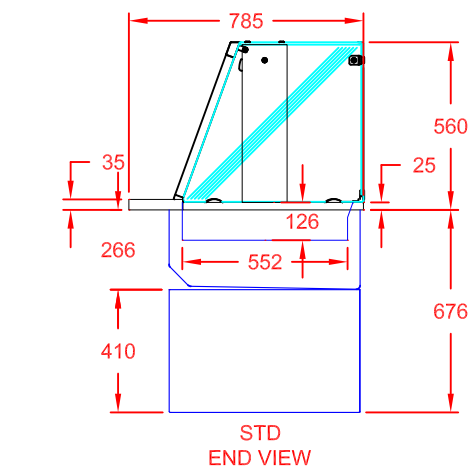
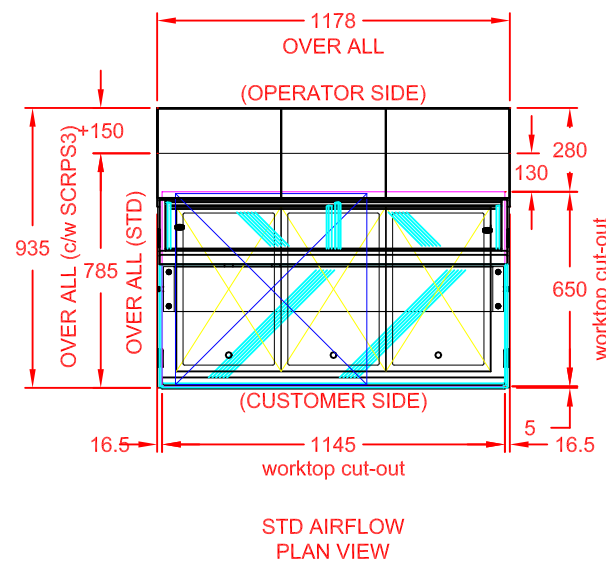
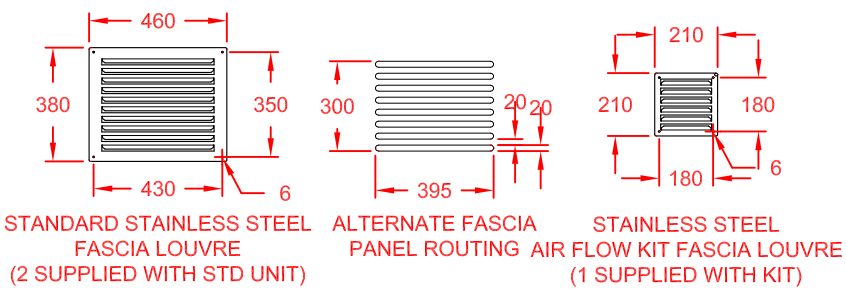

13A PLUG TOP & 2m LEAD
POWER SUPPLY:
13A, 230V, 1.46kW

CUT-OUT FOR AIR GRILLE IN FRONT FASCIA

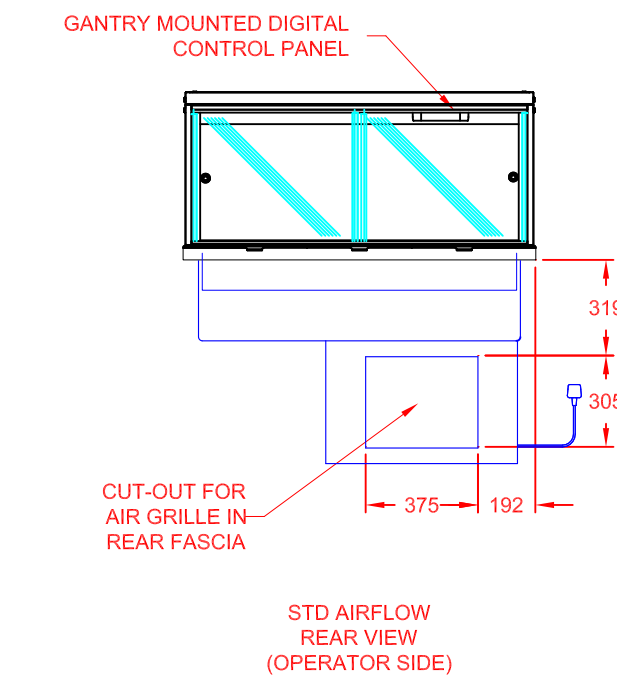

GANTRY MOUNTED DIGITAL CONTROL PANEL

CUT-OUT FOR AIR GRILLE IN REAR FASCIA

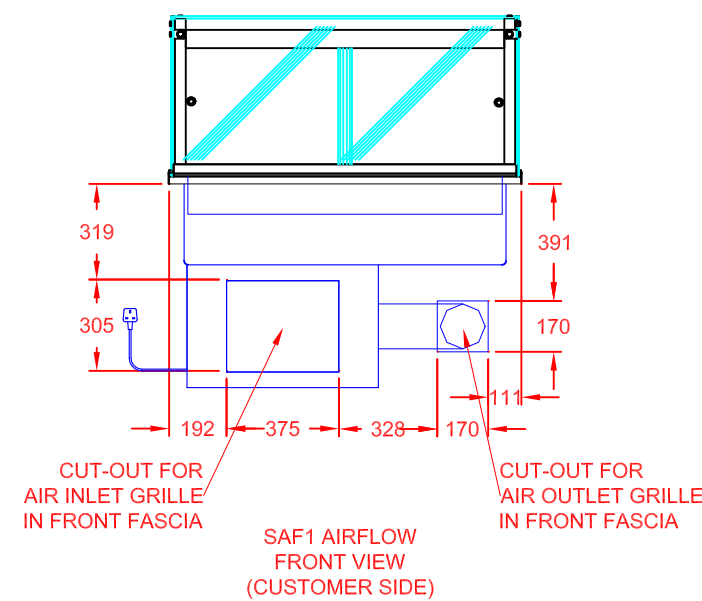
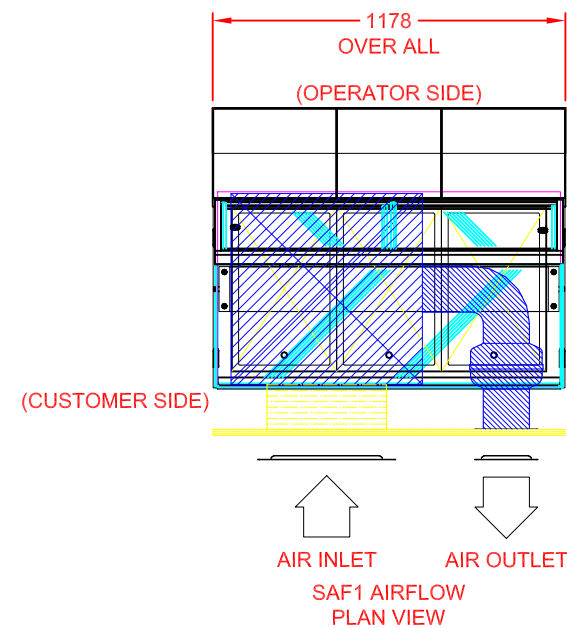
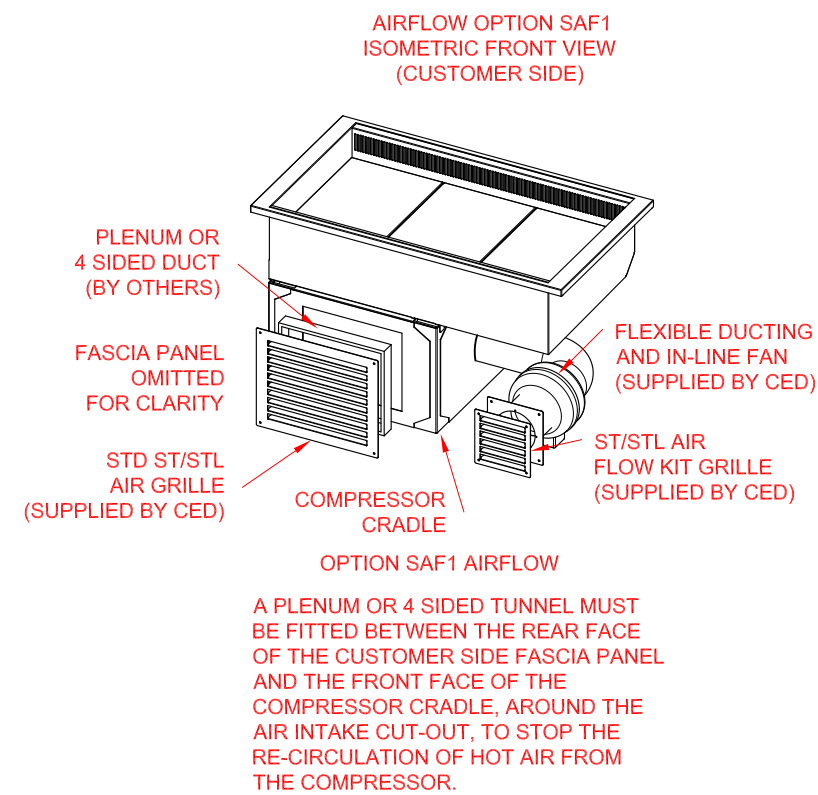

CUT-OUT FOR AIR INLET GRILLE IN FRONT FASCIA

CUT-OUT FOR AIR OUTLET GRILLE IN FRONT FASCIA

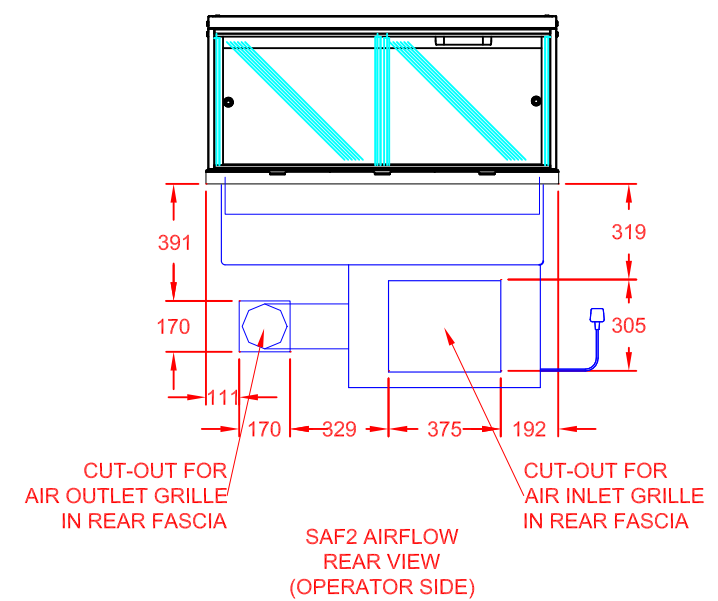
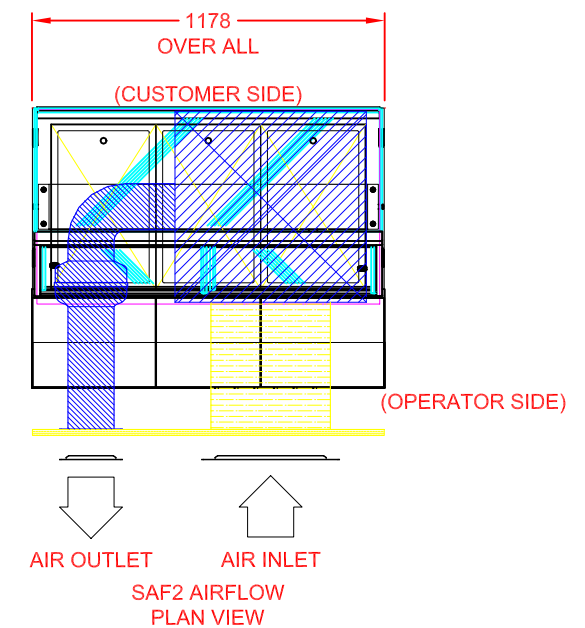
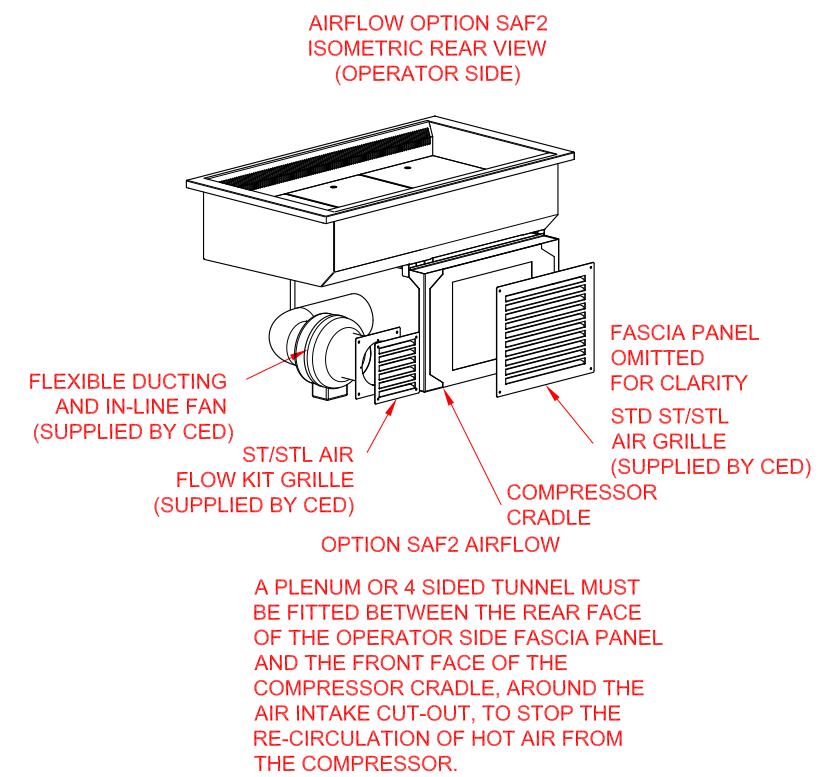

CUT-OUT FOR AIR OUTLET GRILLE IN REAR FASCIA

CUT-OUT FOR AIR INLET GRILLE IN REAR FASCIA



CED FABRICATIONS LTD
UNITS A1-A4, FALCON COURT
CLAYTON BUSINESS PARK
CLAYTON-LE-MOORS
HYNDBURN
LANCASHIRE BB5 5JD

This drawing and information herein is confidential to CED Fabrications Ltd. It is issued in confidence that it will not be disclosed to any third party in part or in whole without permission from CED FABRICATIONS Ltd.

© CED FABRICATIONS LTD

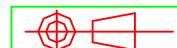

APPROX. UN-CRATED
WEIGHT OF UNIT: 140Kg

DESCRIPTION:

SCENIC DROP-IN CHILLED
3-1 G_n DELI (ASSISTED SERVE)
HYDROCARBON TYPE-R290 REFRIGERANT

SCALE: 1:25@A2 REV No: -

PRODUCT
CODE:

SCDL3ASHT