

WALL-MOUNTED SHELVES

Stainless steel construction. 4 welded tubular bars 25 x 25 mm on 2 consoles (3 consoles for the length of 2200 mm). Wall-mounting by screws. Distributed load: 150kg (according to type of wall). NF Food-Hygiene certification.

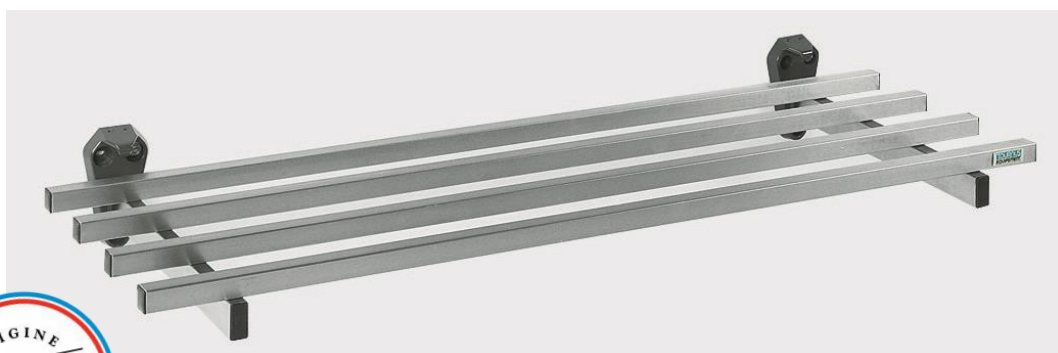

Descriptions	Overall dim. W x L (mm)	References
Wall-mounted shelf with 4 bars	400 x 800	805 715
	400 x 1000	805 720
	400 x 1200	805 721
	400 x 1400	805 722
	400 x 1500	805 726
	400 x 1600	805 723
	400 x 1800	805 724
	400 x 2000	805 725
	400 x 2200	805 727

Technical Data sheet

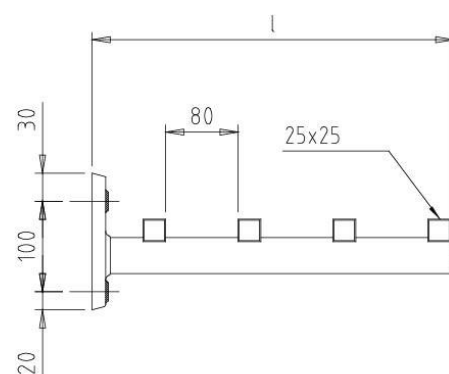
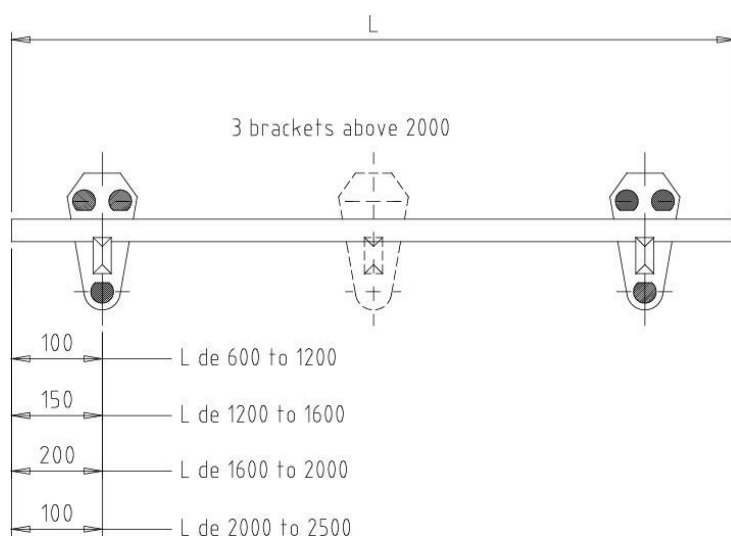

GENERAL SPECIFICATIONS

- Made of food quality stainless steel.
- 4 food quality stainless steel tubular bars 25 x 25 mm.
- Fixed by 6 screws (2 consoles) up to 2000 mm, 9 screws (3 consoles) beyond.
- Maximum distributed load: 150 kg (according to type of wall).
- Options:
 - o Positioning shelves on top of one another to obtain several levels
 - o Positioning them side by side to extend the length
 - o Other made-to-measure dimensions

W x L (mm)	Reference	Weight (kg)
400 x 600	805 714	3.5
400 x 800	805 715	4.3
400 x 1000	805 720	5
400 x 1200	805 721	5.7
400 x 1400	805 722	6.4
400 x 1500	805 726	6.8
400 x 1600	805 723	7.2
400 x 1800	805 724	7.9
400 x 2000	805 725	8.6
400 x 2200	805 727	10

The NF Food Hygiene mark, delivered by AFNOR Certification, certifies compliance with the standard NF031, accessible on www.marque-nf.com, guaranteeing easy cleaning.